

Mid-Century Modern Media Cabinet

By **DIY Huntress**

Difficulty

Moderate

Mid-Century Modern media cabinets don't have to break the bank. Check out how simple it is to build trendy storage on a tight budget! Hint: it only took one sheet of plywood to build!

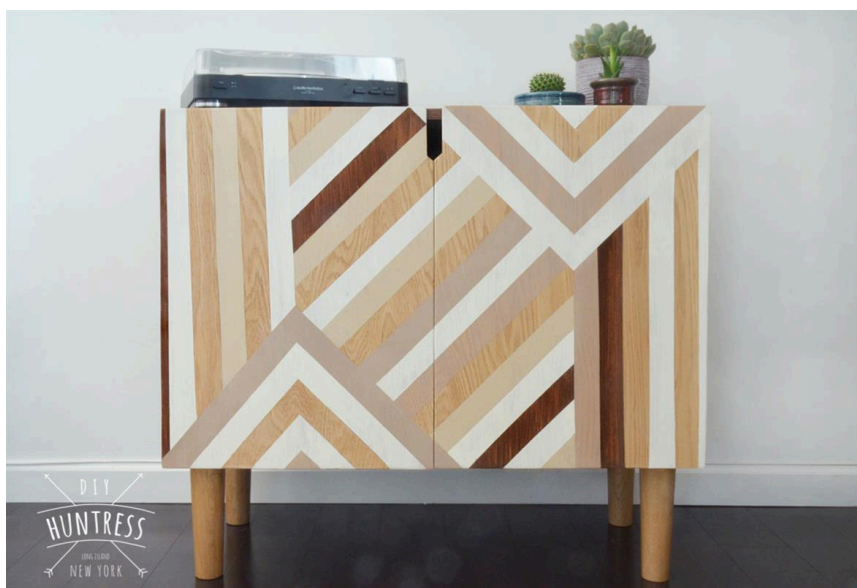

Tools

Kreg Tools

- [Accu-Cut™](#)
- [Kreg® Pocket-Hole Jig 720](#)
- [Cabinet Hardware Jig](#)
- [Mobile Project Center](#)

Other Tools

- Circular Saw (cordless)
- Jigsaw
- Square
- Clamps
- Drill (cordless)
- Sander

Materials

Wood Products

- 1** Plywood , 3/4" Thick , Full Sheet

Hardware & Supplies

- 4** Full Overlay Door Hinges
- 25** 1 1/4" Pocket Hole Screws
- 4** Tapered Legs & Hardware

Cut List & Parts

- 1 Top , 15 X 34"
- 1 Bottom , 15 X 34"
- 2 Sides , 15 X 21"
- 1 Shelf , 14 1/2 X 32 1/2"
- 1 Back Panel , 21 X 32 1/2"
- 2 Doors , 17 X 22 1/2"

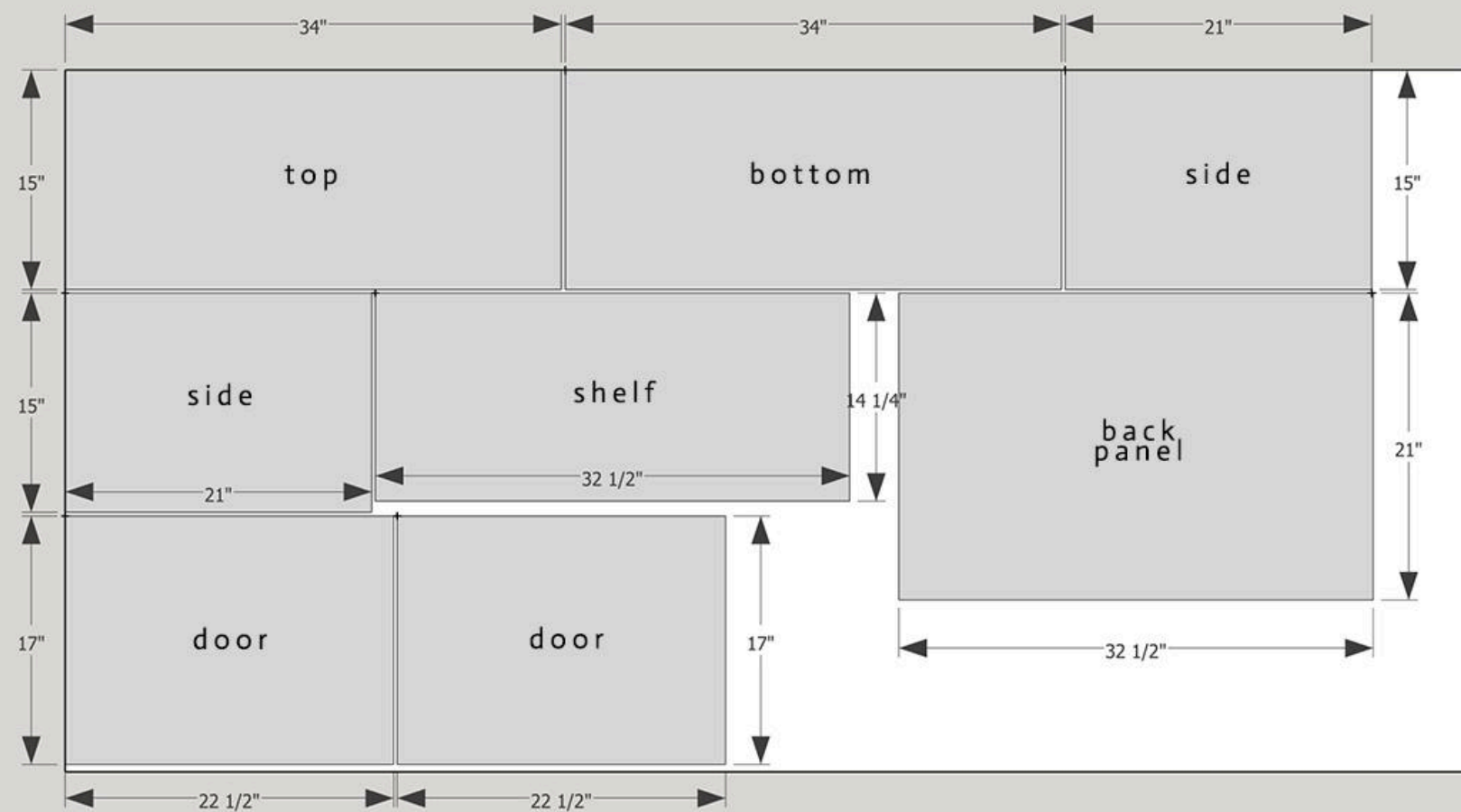

mid-century modern media cabinet -- plans by diy huntress

Directions

1

Check Dimensions

Check the dimensions of the project to make sure it fits your space.

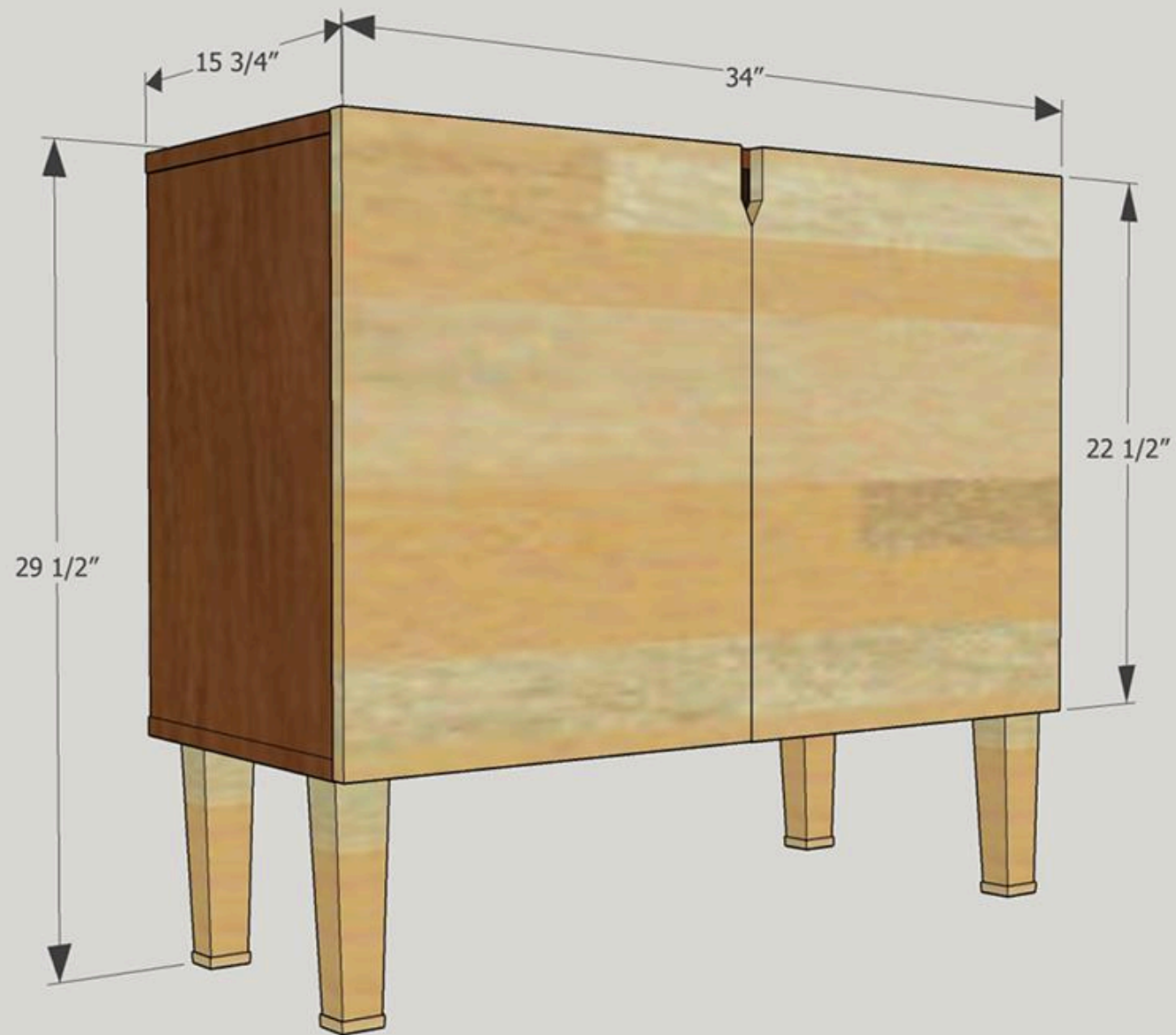

mid-century modern media cabinet -- plans by diy huntress

2

Make Cuts

Use the cut list to make your cuts.

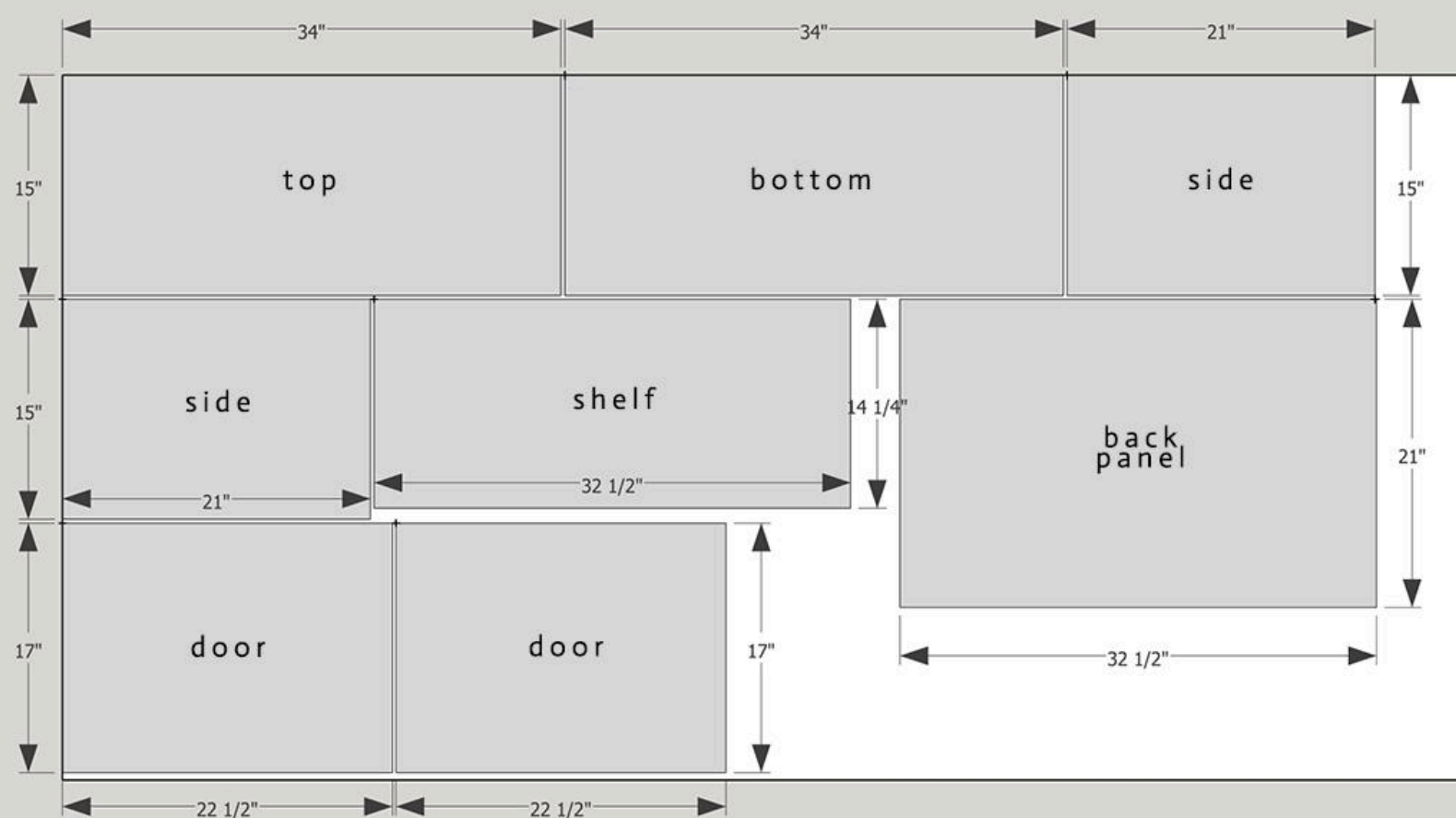

mid-century modern media cabinet -- plans by diy huntress

3

Create Frame

Create your frame by attaching top, bottom, and side pieces with 1 1/4" pocket hole screws and glue.

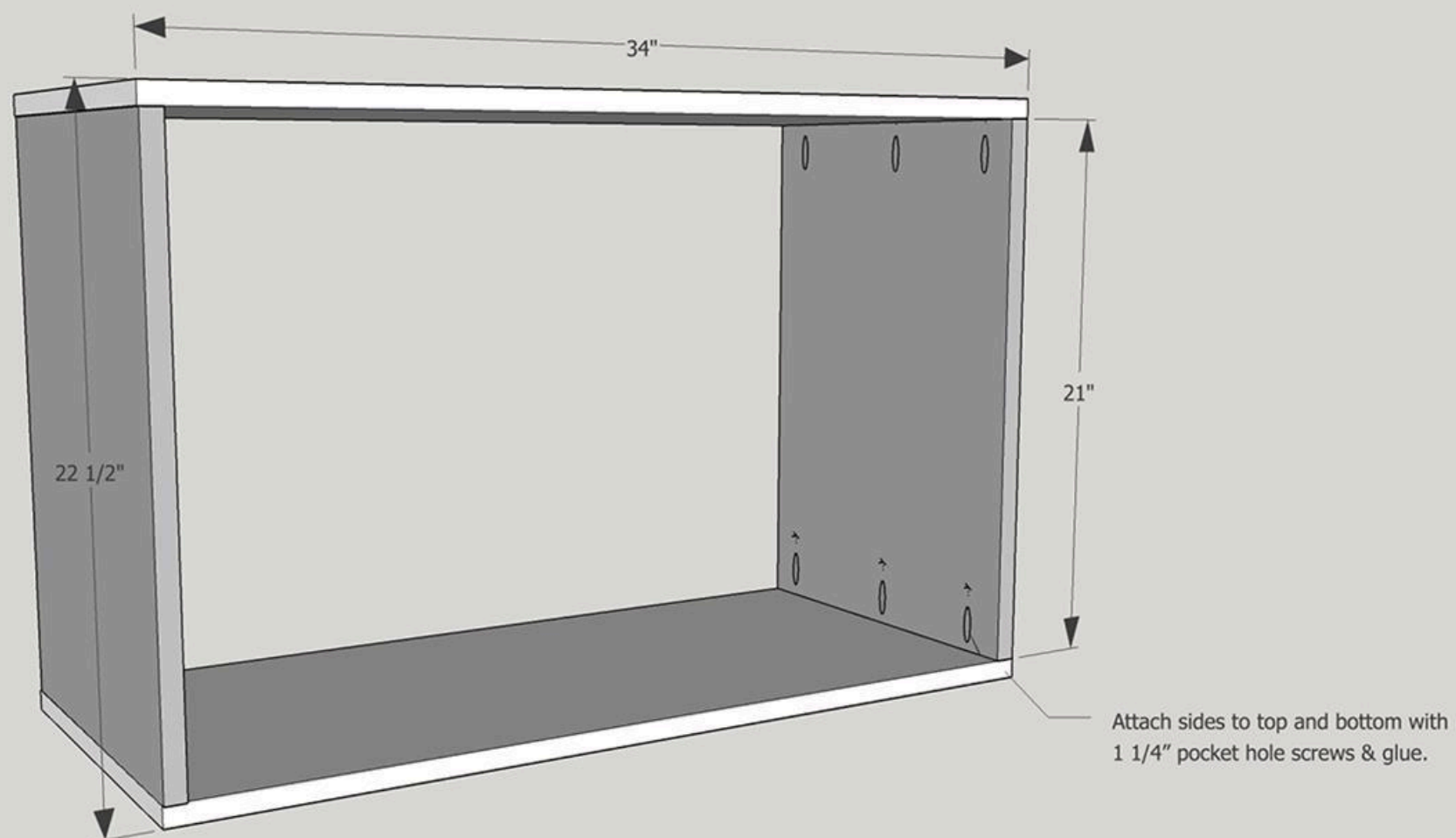

mid-century modern media cabinet -- plans by diy huntress

4**Add Back Panel**

Add back panel with 1 1/4" pocket hole screws and wood glue.

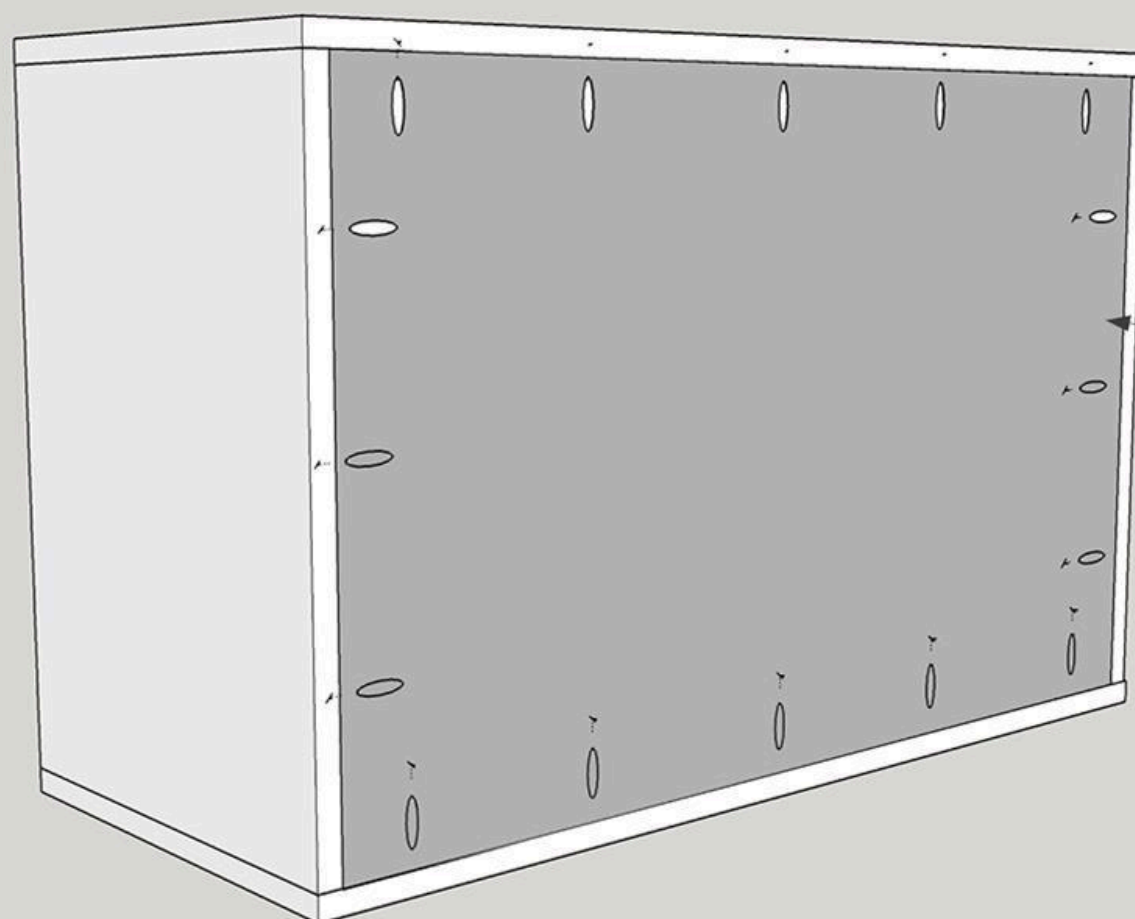

Attach back panel to frame
with 1 1/4" pocket hole screws
& wood glue.

mid-century modern media cabinet -- plans by diy huntress

5**Add Shelf (Optional)**

Add a shelf to your build with 1 1/4" pocket hole screws & wood glue, if needed. I used mine for a 3D printer, so no shelving was added!

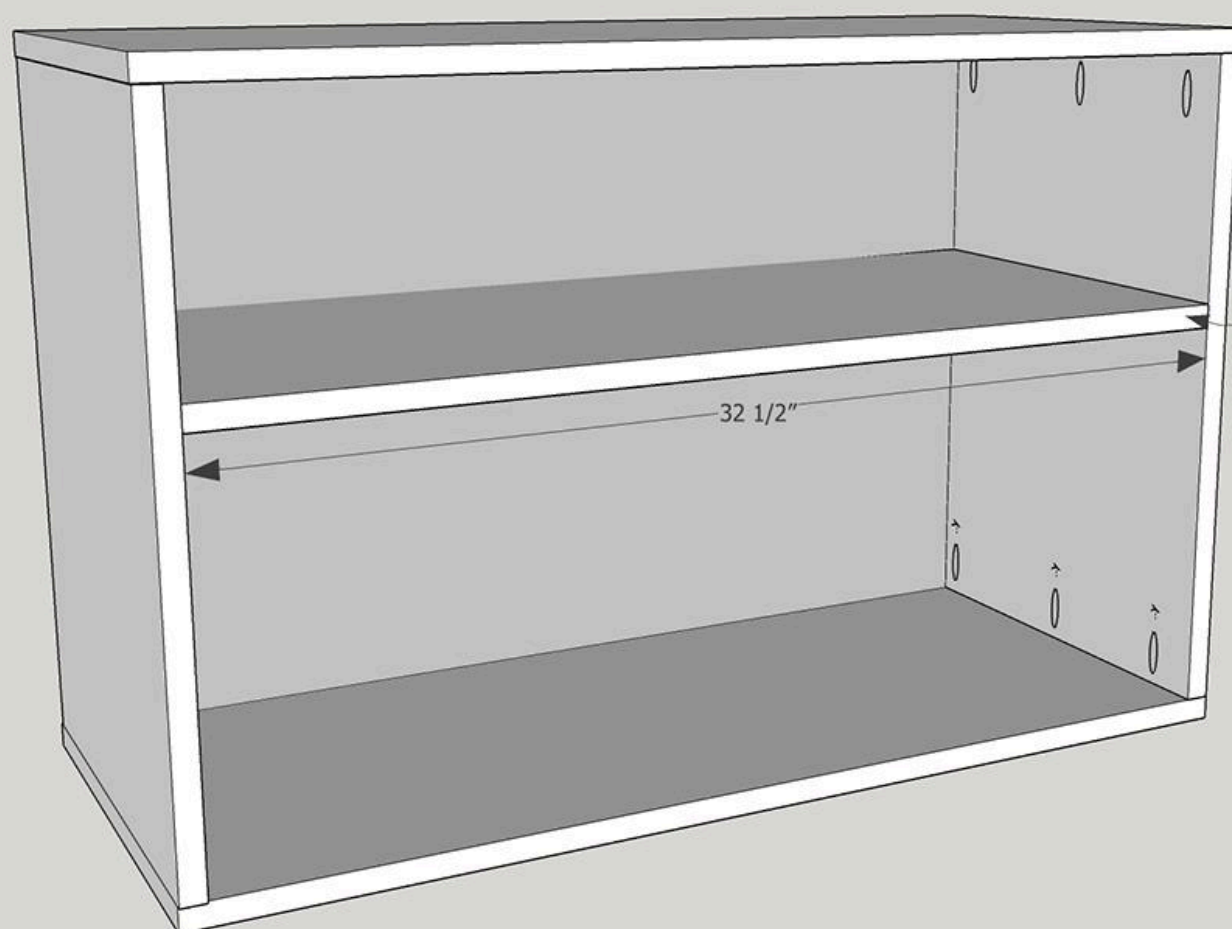

Attach shelf to inside of unit
with 1 1/4" pocket hole screws
& wood glue.

mid-century modern media cabinet -- plans by diy huntress

6**Create Handle Cut Outs**

Use a jig saw to create cut outs for the door handles. The ones on this particular cabinet are 1/2" wide and 3" tall on each door.

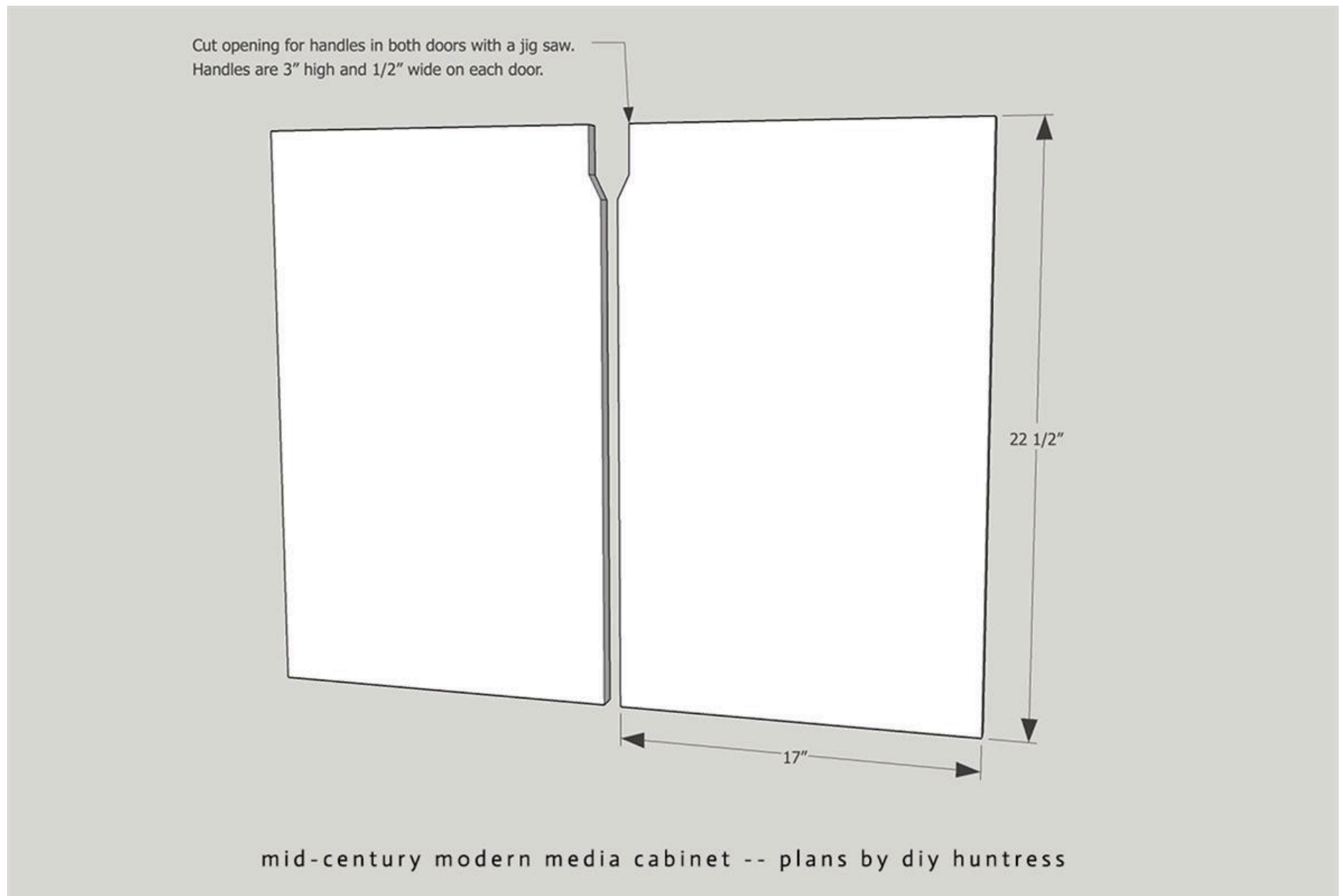

7

Attach Doors

Use the Kreg cabinet hardware jig to add your full overlay concealed hinges.

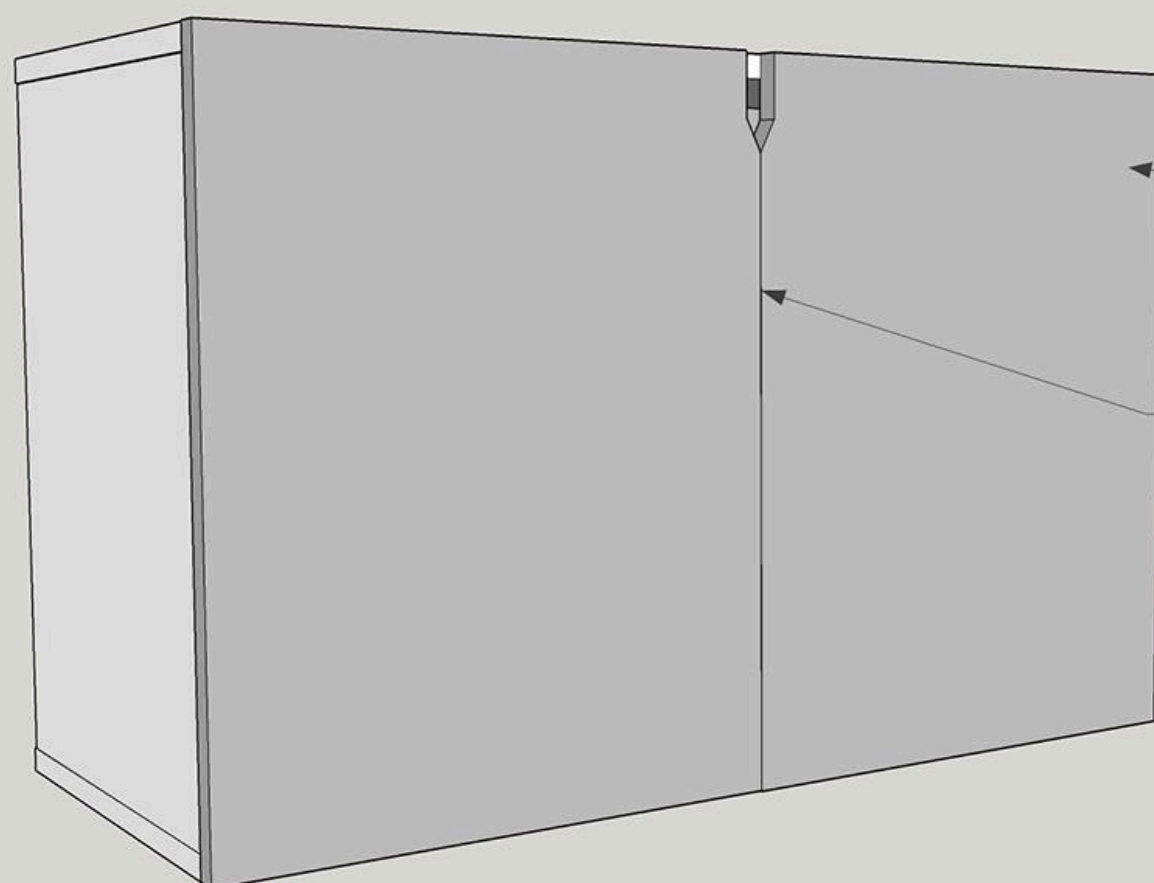

Attach doors to cabinet using full overlay hingest.

When attaching doors, make sure to leave 1/8" gap between doors. This can be adjusted/customized when installing.

mid-century modern media cabinet -- plans by diy huntress

8

Add Legs

Add your legs as per manufacturer directions. Visit my website at diyhuntress.com for a link to the exact legs used in this build.

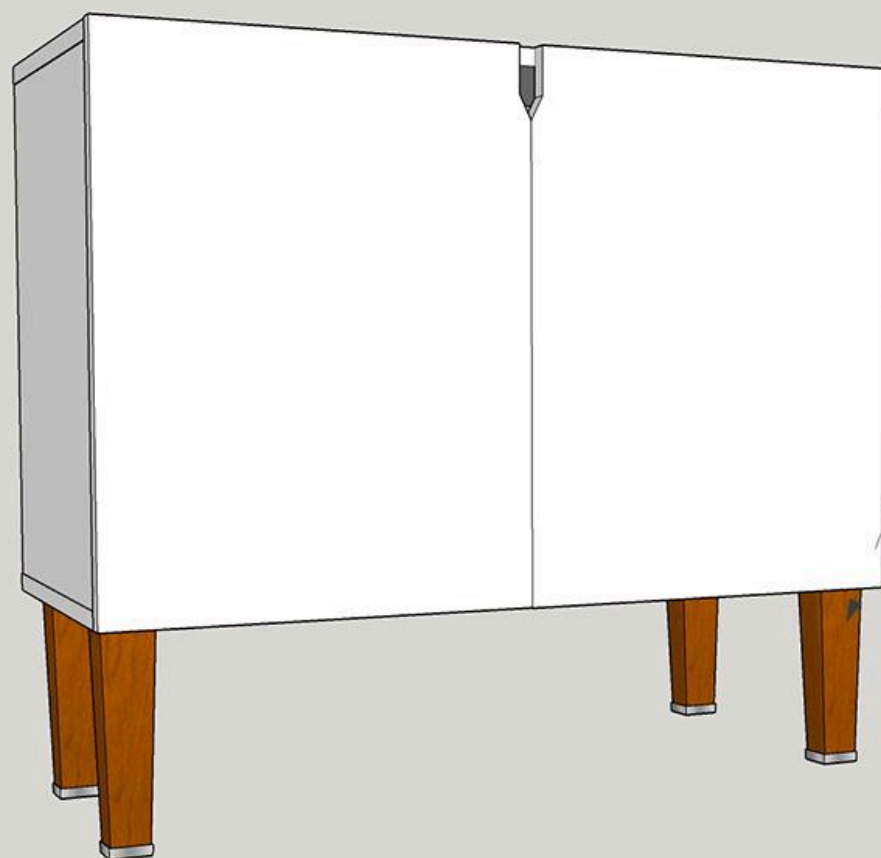

Install legs as per manufacturer's instructions.
For exact legs used in this project, visit
www.diyhuntress.com and search for "Media Cabinet".

mid-century modern media cabinet -- plans by diy huntress

9

Sand & Stain

Stain your piece! Add artwork to the front to help the unit pop!



mid-century modern media cabinet -- plans by diy huntress